

## Coro piano cover pro datasheet

LED recessed spotlight with zoom optics (swivable) for hollow ceilings or solid ceilings with ceiling box. model with cover ring for magnetical attachment. The spotlight is mounted with a simple tension spring mechanism and requires no screw fittings. Version with remote power supply unit, connection to external constant current power source (driver). Dimmable via customer-supplied dimmable power supply unit. The zoom optics can be rotated by 360° (with stop), swiveled by 30° and the light cone can be continuously adjusted within 25–60°.

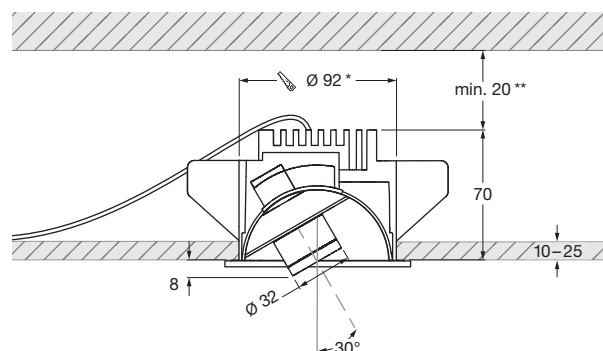
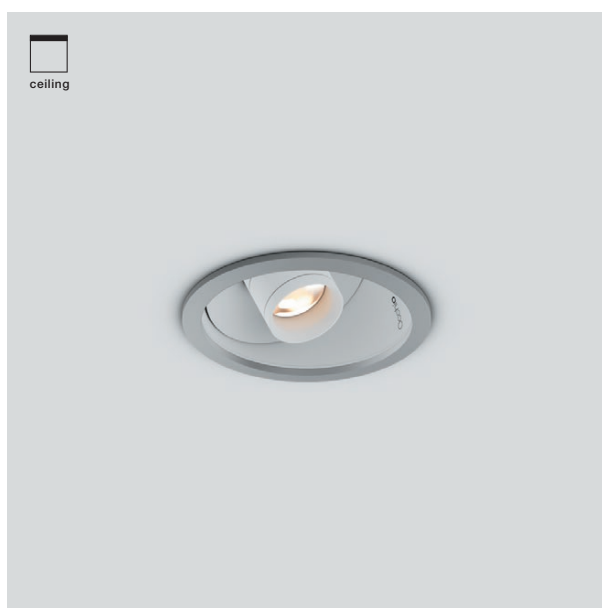

\* cut-out dimensions

\*\* minimum thermal distance, installation height depending on driver

dimensions in mm

### technical data Coro piano cover pro

properties	material	aluminium, glass, PVD coated, painted, plastic
	turning range	360° (with stop)
	mobility head	30°
	weight	0,6 kg
surface	zoom	bronze, matt gold, rose gold, matt silver, matt white, matt black, phantom, black phantom
	tube	matt white, matt black
	cover	bronze, matt gold, rose gold, matt silver, phantom, black phantom
Occhio LED	average life time	> 50.000 hrs
	energy efficiency class (luminous efficiency)	G (65 lm/W, @4000 K single color)
	power	LED 9 W
	color rendering index	CRI Ra 92
	color temperature (color consistency)	single color: 2700 K, 3000 K, 4000 K (2-step) color tune: 2200–3500 K (2-step)      2700–4000 K (2-step)
electricity	dimming	with suitable power supply unit
	connection	single color (1-channel): max. 500 mA / 18 VDC color tune (2-channel): max. 1000 mA total current (I <sub>1</sub> + I <sub>2</sub> ) / 9 VDC per channel
	permitted operating conditions	max. 30°C for indoor use only

Coro piano cover pro  
lighting effects

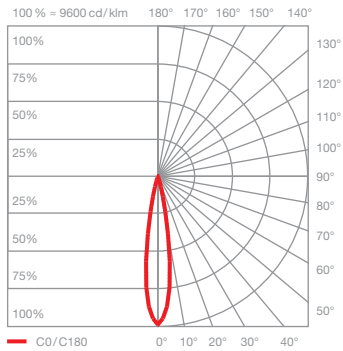
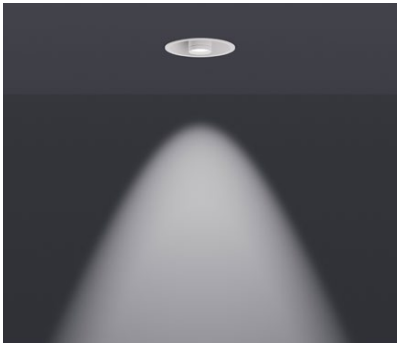

<b>Z25</b>		
directed light (approx. 25°)		
optics:	zoom lens	
power:	high color	9 W
luminous flux:	2700 K	400 lm
	3000 K	420 lm
	4000 K	480 lm
	2200–3500 K	170–230 lm
	2700–4000 K	200–240 lm

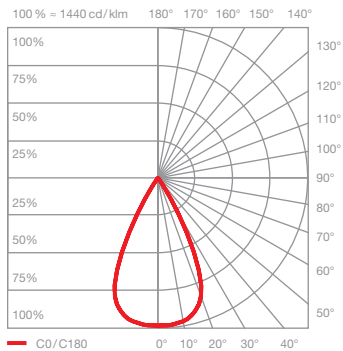
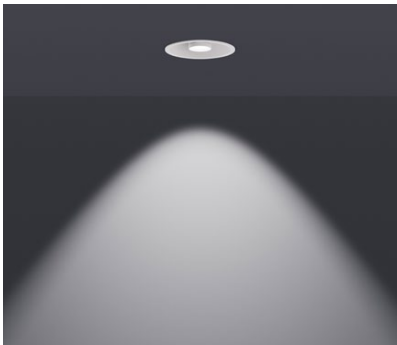

<b>Z60</b>		
directed light (approx. 60°)		
optics:	zoom lens	
power:	high color	9 W
luminous flux:	2700 K	450 lm
	3000 K	480 lm
	4000 K	540 lm
	2200–3500 K	320–420 lm
	2700–4000 K	370–450 lm